



# **PUSH-FIT VALVES & FITTINGS**

---

## **PUSH-FIT VALVES & FITTINGS**

A.Y. McDonald Mfg. Co. Push-Fit Valves & Fittings are designed for use on copper tubing, pex tubing, and CPVC pipe. Push-Fit fittings eliminate the need for soldering, crimping, or solvent welding and are designed for above ground indoor water applications. Push-Fit fittings comply with all applicable standards and are pressure rated at 200 PSIG from 0° to 200°F.

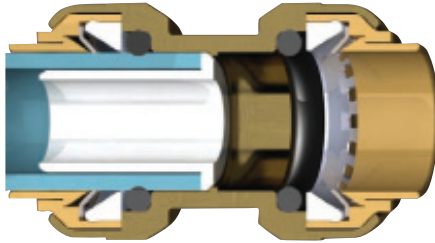

A.Y. McDonald Mfg. Co. Push-Fit Valves & Fittings are a 21st century design for connecting fittings and valves to Copper, CPVC or Pex pipe. No soldering, crimping, or solvent welding is necessary due to the special rubber O-ring and stainless steel grip ring. The permanent connection is established in seconds and is capable of test pressures exceeding 500 psi. Push-Fit fittings are produced with low-lead forged brass and are ideal for use on plumbing, water, and hydronic heating systems. The sleek disconnect clip allows the Push-Fit design to disassemble as fast as you can say Push-Fit! Unlike other competitors that use multi-step disassembly procedures, the advanced Push-Fit design offers a quick solution to typical installation errors.

### **FEATURES:**

- Fast installation requiring NO special tools.
- Secure, permanent connection with no soldering, crimping, or solvent welding.
- Wet repair of existing plumbing with no drying time required.
- Allows easy transition from one tubing type to another.
- 360° tubing rotation and easy pre-assembly installation.
- Full port fittings for usage on domestic hot and cold water systems.
- NO soldering, NO flux, NO flame, NO fire hazards.
- Manufacturing procedures and processes in accordance with ISO 9001.

**A.Y. McDONALD MFG. CO. • P.O. BOX 508 • DUBUQUE, IA 52004-0508**  
**800-292-2737 • FAX 800-832-9296 • sales@aymcdonald.com • www.aymcdonald.com**  
(Push Fit 3/10)



# PUSH-FIT VALVES & FITTINGS

## PUSH-FIT VALVES & FITTINGS

PUSH-FIT Valves & Fittings connect to copper tubing, pex tubing and/or CPVC pipe. No soldering, crimping or solvent welding is necessary due to the special rubber gasket and stainless steel grip ring within the fitting's socket end. The fittings are produced from low lead forged brass and are ideal for use on above ground plumbing, water systems and hydronic heating systems.

- **Typical applications:**

Above ground plumbing, water systems and hydronic heating systems

- **Use with:**

Pex tubing in accordance with ASTM F-876 and F-877  
Copper tubing in accordance with ASTM B88  
CPVC tubing in accordance with ASTM D2846/2846M-99

- **Material:**

Body - Forged brass C36500 (Low Lead)  
O-Ring - EPDM Rubber  
Gripper Ring - Stainless Steel  
Stiffener - Polysulfone  
Plastic Parts - Acetal (POM)

- **Conformance:**

Manufactured in Accordance to ANSI/ASSE 1061  
CSA B137.5 Listed, Adapter threads to ANSI B1.20.1  
Adapter solder ends to ANSI B16.18

- **Pressure and Temperature:**

Push-Fit Fittings are pressure rated at 200 psig (13.8 bar) over a temperature range from 0°F to 200°F (-18°C to 93°C)

- **Quality Assurance:**

The robust Push-Fit design has been tested and certified to meet ASSE 1061, ANSI / NSF 14, and ANSI / NSF 61 standards for materials and performance. All components are CNC machined, precision stamped, or injection molded to insure 100% conformance to design specifications. The end user may specify and install Push-Fit products with confidence.

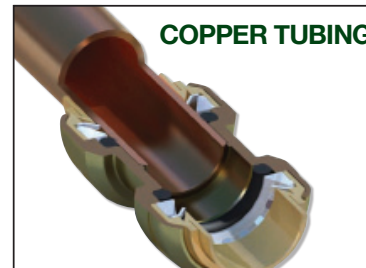



# PUSH-FIT VALVES & FITTINGS

## PUSH-FIT VALVES & FITTINGS

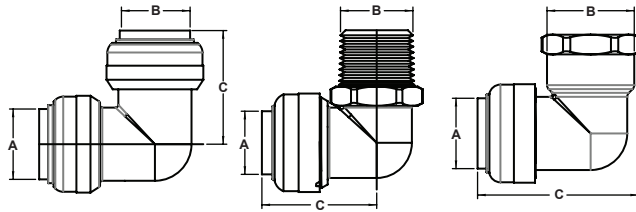

~ DIMENSIONS ~

Part No.	Description	A	B	C
2190	Elbow	3/8"	3/8"	1.21
2190	Elbow	1/2"	1/2"	1.30
2190	Elbow	3/4"	1/2"	1.56
2190	Elbow	3/4"	3/4"	1.59
2190	Elbow	1"	3/4"	1.82
2190	Elbow	1"	1"	1.91
2190M	Elbow	1/2"	1/2" MNPT	1.32
2190F	Elbow	1/2"	1/2" FNPT	1.88
2190F	Elbow	3/4"	3/4" FNPT	2.25

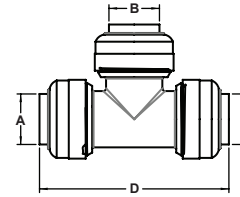

~ DIMENSIONS ~

Part No.	Description	A	B	C	D
2130	Tee	3/8"	3/8"	3/8"	2.42
2130	Tee	1/2"	1/2"	1/2"	2.65
2130	Tee	3/4"	3/4"	3/4"	3.18
2130	Tee	1"	1"	1"	3.80
2130	Tee	3/8"	3/8"	1/2"	2.56
2130	Tee	3/4"	1/2"	1/2"	3.00
2130	Tee	3/4"	1/2"	3/4"	3.10
2130	Tee	3/4"	3/4"	1/2"	3.11
2130	Tee	1"	1"	3/4"	3.51

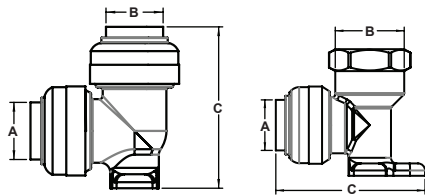

~ DIMENSIONS ~

Part No.	Description	A	B	C
2101Q	Drop Ear Elbow	1/2"	1/2" FNPT	2.10

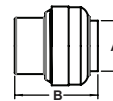

~ DIMENSIONS ~

Part No.	Description	A	B
2103	Test Cap	3/8"	1.00
2103	Test Cap	1/2"	1.16
2103	Test Cap	3/4"	1.21
2103	Test Cap	1"	1.40

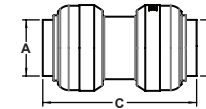

~ DIMENSIONS ~

Part No.	Description	A	B	C
2100	Coupling	3/8"	3/8"	1.80
2100	Coupling	1/2"	1/2"	2.00
2100	Coupling	3/4"	1/2"	2.10
2100	Coupling	3/4"	3/4"	2.31
2100	Coupling	1"	3/4"	2.42
2100	Coupling	1"	1"	3.10



# PUSH-FIT VALVES & FITTINGS

# PUSH-FIT VALVES & FITTINGS

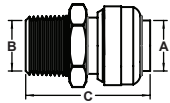

~ DIMENSIONS ~

Part No.	Description	A	B	C
2100M	Male Adapter	3/8"	1/2" MNPT	1.70
2100M	Male Adapter	1/2"	1/2" MNPT	1.81
2100M	Male Adapter	1/2"	3/4" MNPT	1.83
2100M	Male Adapter	3/4"	3/4" MNPT	2.00
2100M	Male Adapter	1"	3/4" MNPT	2.14
2100M	Male Adapter	1"	1" MNPT	2.33

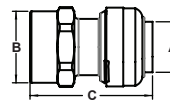

~ DIMENSIONS ~

Part No.	Description	A	B	C
2100F	Female Adapter	1/2"	1/2" FNPT	1.71
2100F	Female Adapter	1/2"	3/4" FNPT	1.60
2100F	Female Adapter	3/4"	3/4" FNPT	2.00
2100F	Female Adapter	1"	1" FNPT	2.14

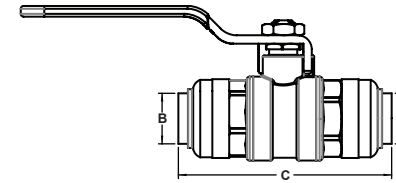

~ DIMENSIONS ~

Part No.	Description	A	B	C
2105	Ball Valve	1/2"	1/2"	2.76
2105	Ball Valve	3/4"	3/4"	3.47
2105	Ball Valve	1"	1"	4.13

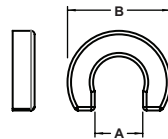

~ DIMENSIONS ~

Part No.	Description	A	B
2100RT	Disconnect Tool	3/8"	1.22
2100RT	Disconnect Tool	1/2"	1.22
2100RT	Disconnect Tool	3/4"	1.72
2100RT	Disconnect Tool	1"	2.08

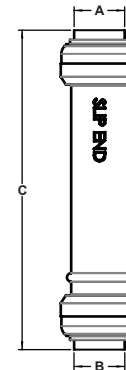

~ DIMENSIONS ~

Part No.	Description	A	B	C
2100RC	Slip Repair Coupling	1/2"	1/2"	4.45
2100RC	Slip Repair Coupling	3/4"	3/4"	4.45
2100RC	Slip Repair Coupling	1"	1"	4.45