



INDUSTRIAL & SPECIALTY VALVES / FITTINGS

2110 DIELECTRIC UNIONS

For use wherever dissimilar metals are used in a piping system. Prevents pipe deterioration from corrosion due to galvanic and stray currents. Contact factory for repair parts.

- **Inlet:** FIP Thread Union
- **Outlet:** Copper Sweat
- **Sizes:** 1/2", 3/4", 3/4" x 1/2", 1", 1 1/4", 1 1/2", 2"

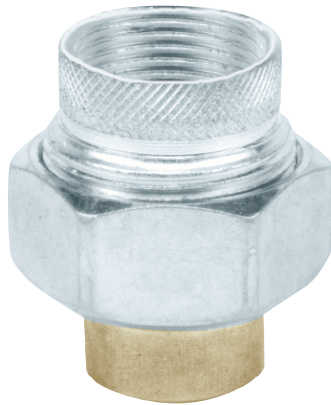

~ MATERIALS ~		
NO.	PART	MATERIAL
1	I.P.S. Connection	Forged Steel
2	Nut	Forged Steel
3	Solder Connection	Brass
4	Gasket	EPDM
5	Insert	ABS

~ DIMENSIONS ~					
SIZE	A	B	C	D	E
1/2	1.63	1.04	.72	1.85	.82
3/4	1.85	1.26	.72	2.03	1.07
3/4 x 1/2	1.85	1.26	.72	1.89	.82
1	2.14	1.54	.72	2.27	1.32
1 1/4	2.56	1.86	.85	2.52	1.57
1 1/2	2.95	2.15	.97	2.53	1.83
2	3.76	2.74	1.06	2.85	2.38

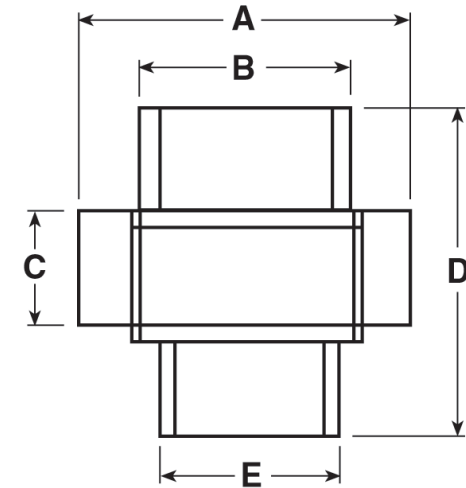

- 200 PSI, 180°F maximum